



5841 Bridge Street
East Syracuse, NY 13057



SPACE FOR LEASE



- Highly Visible End-Cap Position Facing Bridge Street
- Easy Access to I-690, I-481 and I-81
- 9500 SF **Ideal for a Medical Office or Retail Space**

Grazi Zazzara JR :
Gzazzara@TheIconCompanies.com

344 S. Warren Street Syracuse, NY 13202
315.299.6292 TheIconCompanies.com

The information contained herein has been obtained from sources believed to be reliable, however, The Icon Companies and/or its affiliates have not verified its accuracy and make no guarantee, warranty or representation concerning any information herein. All information herein is subject to change without notice at any time.



5841 Bridge Street
East Syracuse, NY 13057



SPACE FOR LEASE

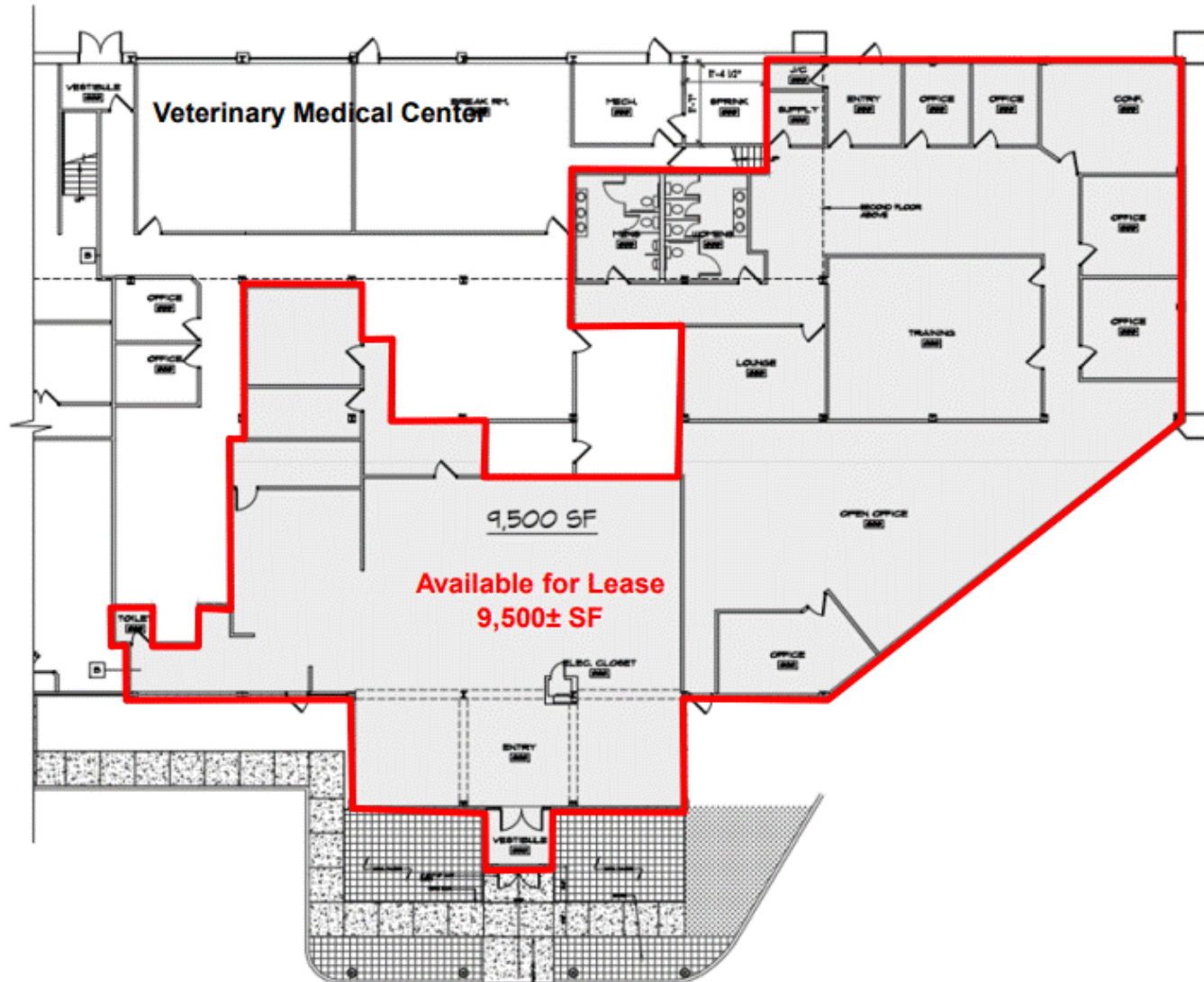

Floor Plan

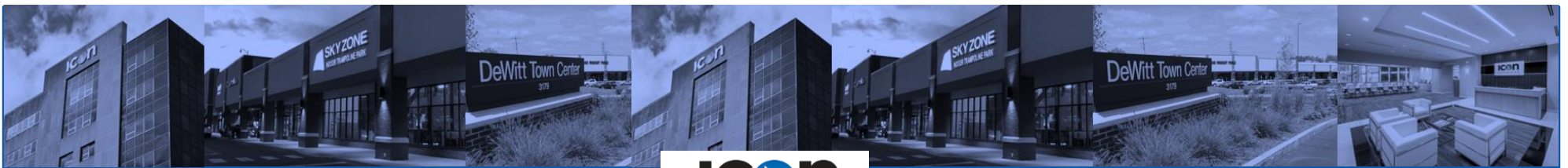

5841 Bridge Street
East Syracuse, NY 13057



SPACE FOR LEASE



Demographics 2021	1 Mile	3 Miles	5 Miles
Total Population	5,232	59,530	164,484
Total Household	2,032	25,272	65,394
Median Income	53,482	60,489	46,111

Traffic Counts	2019
Bridge Street	16,055 AADT
I-690 at Exit 17	37,617 AADT